



nz mastermap

the source of all geographic information

14. CRS - CORE RECORD SYSTEM

NZ MasterMap CRS is Land Information New Zealand's official legal view of New Zealand. CRS is available as an additional layer allowing you to compare the legal definition and real world views of land parcels and addresses.

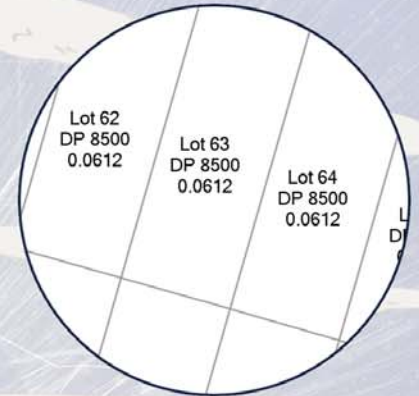

CRS is the NZ Government's main database for recording cadastral information. It is the official legal view of New Zealand cadastre and this data is captured by surveyors to support the Land Tenure system within New Zealand. Terralink processes this data and can provide any type of CRS information including the following:

- Addresses
- Survey Parcels
- Road Centreline and Names
- Railway Centrelines
- Title References
- Easements

NZ MasterMap adds value by combining CRS data with other relevant information such as:

- Sales data
- Valuation

CRS is updated monthly.



For more information on NZ MasterMap call freephone 0508 483 772
or email info@terralink.co.nz

www.terralink.co.nz

